

C02	26/08/2020	DC	DELINEATED EASTBOUND CYCLE LANE ALONG HASLETT AVENUE E TO THE EAST OF HAZEWCCK AVENUE HAS BEEN REMOVED, AND SIGNAGE AND ROAD MARKINGS AMENDED AS A RESULT.	PG	BS
C01	18/08/2020	DC	ISSUE FOR CONSTRUCTION	PG	BS
P01	14/08/2020	DC	FIRST DRAFT ISSUE FOR COSTING	PG	
REV	DATE	BY	DESCRIPTION	CHK	APP

DRAWING STATUS: A - FIT FOR CONSTRUCTION



2 London Square, Cross Lanes, Guildford, Surrey, GU1 1UN
T+ 44 1483 528 400
wsp.com

CLIENT:

WEST SUSSEX COUNTY COUNCIL,
INFRASTRUCTURE GROUP,
COUNTY HALL, WEST STREET,
CHICHESTER, WEST SUSSEX,
PO19 1RH, (01243) 642105.



PROJECT: WSCC TEMP ROAD SPACE REALLOCATIONS
(COVID-19)
DETAILED DESIGN

POUND HILL TO CRAWLEY TOWN CENTRE
SCHEME PLANS
SHEET 001 OF 004

SCALE @ A1: 1:500	CHECKED: DG	APPROVED: BS
PROJECT No: 70073305	DESIGNED: DG	DRAWN: DG
DATE: September 20		
DRAWING No: 70073305-CRW-TB-001		REV: C02
© WSP UK Ltd		

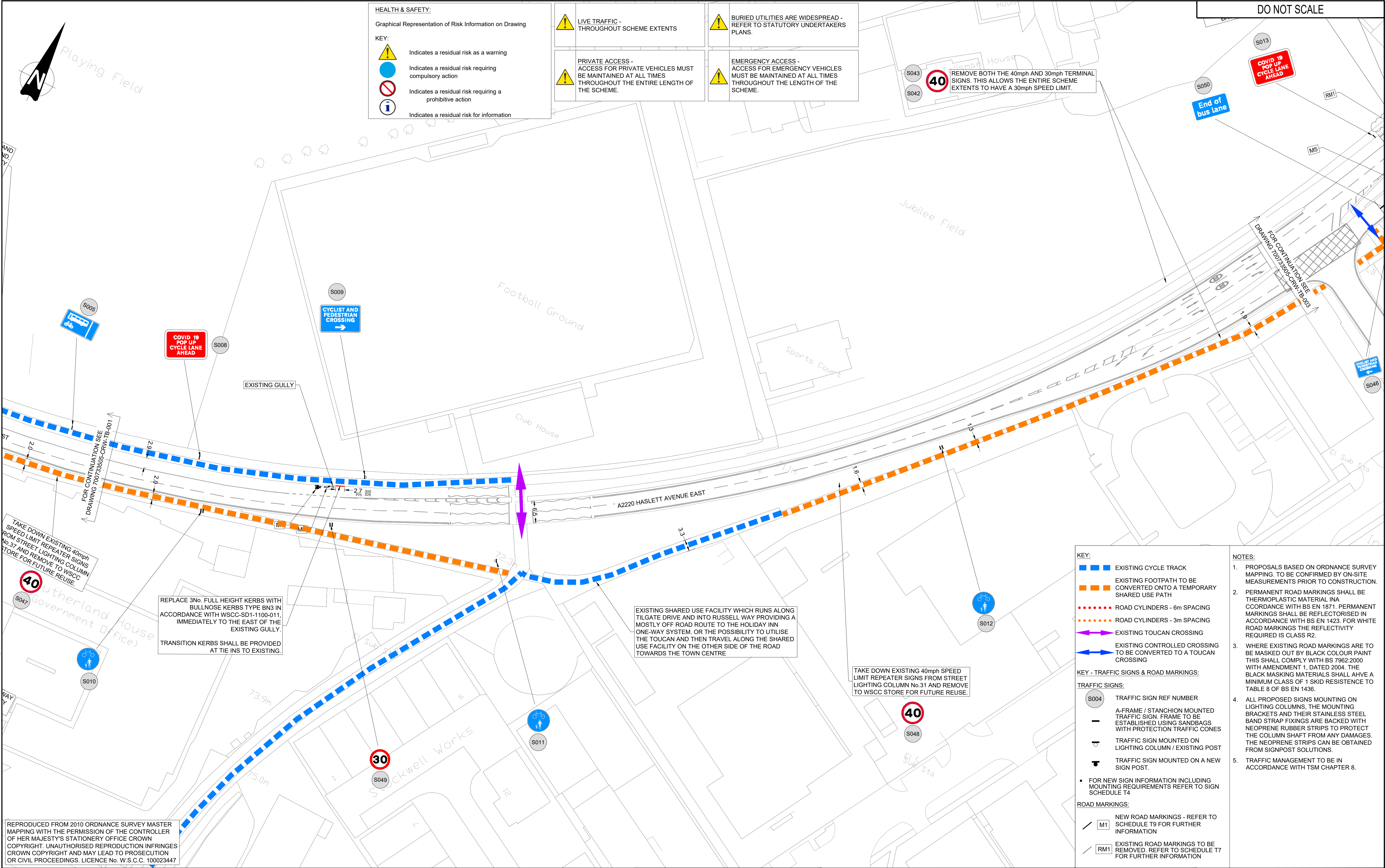

REPRODUCED FROM 2010 ORDNANCE SURVEY MASTER MAPPING WITH THE PERMISSION OF THE CONTROLLER OF HER MAJESTY'S STATIONERY OFFICE CROWN COPYRIGHT. UNAUTHORISED REPRODUCTION INFRINGES CROWN COPYRIGHT AND MAY LEAD TO PROSECUTION OR CIVIL PROCEEDINGS. LICENCE No. W.S.C.C. 100023447

CO2	26/06/2020	DG	DELIMITED EASTBOUND CYCLE LANE ALONG HASLETT AVENUE E TO THE EAST OF HAZELWICK AVENUE. HAS BEEN REMOVED AND SIGNAGE AND ROAD MARKINGS AMENDED AS A RESULT.	DG	PS
CO1	18/08/2020	DG	ISSUE FOR CONSTRUCTION	DG	PS
P01	14/06/2020	DG	FIRST DRAFT ISSUE FOR COSTING	DG	
REV	DATE	BY	DESCRIPTION	CHK	APP
DRAWING STATUS: A - FIT FOR CONSTRUCTION					

wsp

2 London Square, Cross Lanes, Guildford, Surrey, GU1 1UN
T+ 44 1483 528 400
wsp.com

CLIENT:

WEST SUSSEX COUNTY COUNCIL,
INFRASTRUCTURE GROUP,
COUNTY HALL, WEST STREET,
CHICHESTER, WEST SUSSEX,
PO19 1RH, (01243) 642105.

west sussex county council

PROJECT: WSCC TEMP ROAD SPACE REALLOCATIONS (COVID-19) DETAILED DESIGN

TITLE: POUND HILL TO CRAWLEY TOWN CENTRE SCHEME PLANS SHEET 002 OF 004

SCALE @ A1: 1:500	CHECKED: DG	APPROVED: BS
PROJECT No: 70073305	DESIGNED: DG	DRAWN: DG
DRAWING No: 70073305-CRW-TB-002	REV: C02	
© WSP UK Ltd		

File name: C:\Users\lukad\OneDrive - WSP\Documents\WSP\Projects\70073305\CRW-TB-002_COPY.DWG, printed on 08 September 2020 11:56:20, by Gonzalez-Daval, Daniel

wsp

2 London Square, Cross Lanes, Guildford, Surrey, GU1 1UN
T+ 44 1483 528 400
wsp.com

PROJECT:	WSSC TEMP ROAD SPACE REALLOCATIONS (COVID-19) DETAILED DESIGN
TITLE:	POUND HILL TO CRAWLEY TOWN CENTRE SCHEME PLANS SHEET 003 OF 004

SCALE @ A1:	CHECKED:		APPROVED:
1:500	DG		BS
PROJECT No:	DESIGNED:	DRAWN:	DATE:
70073305	DG	DG	September 20
DRAWING No:			REV:
70073305-CRW-TB-003			C02
© WSP UK Ltd			

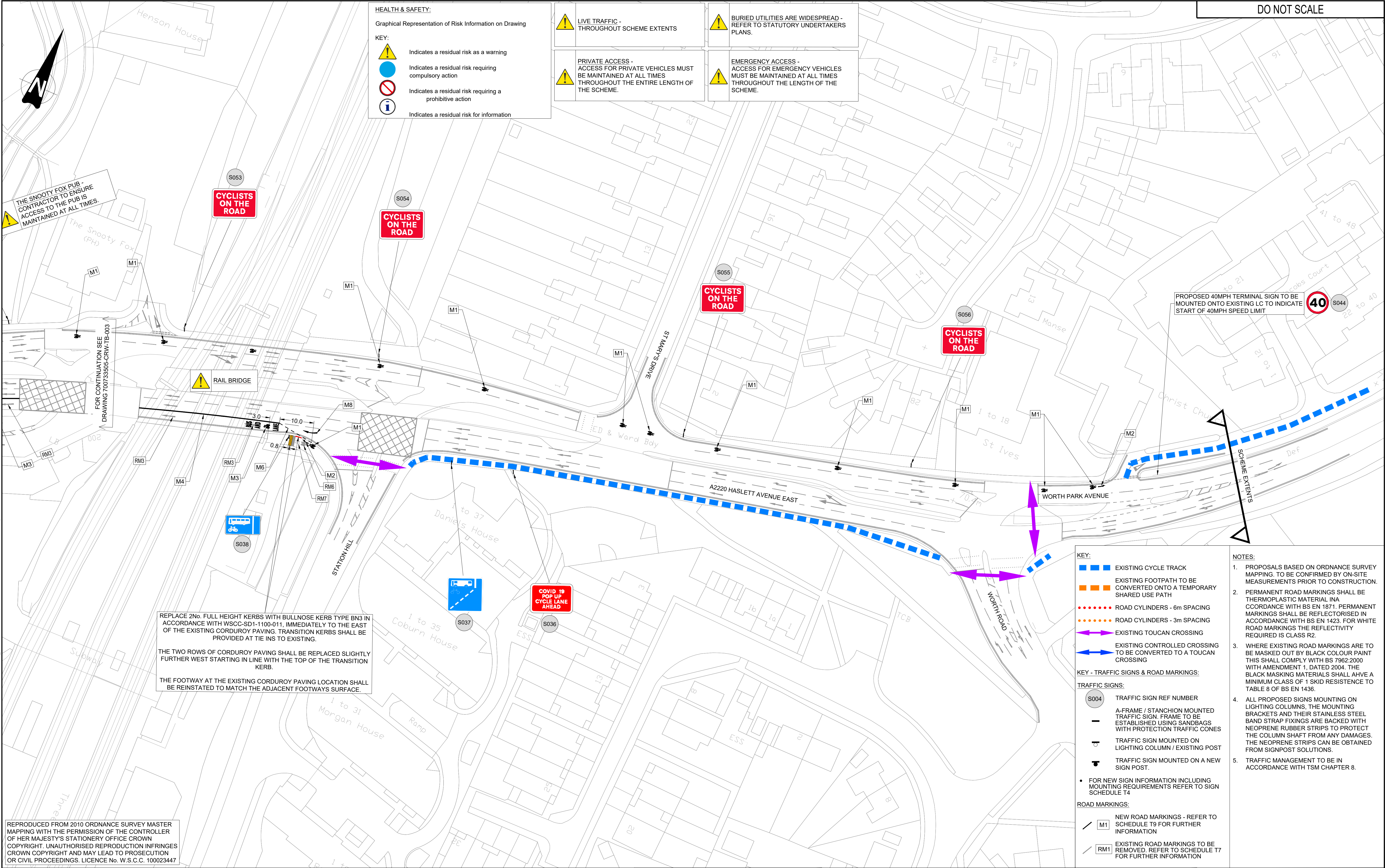

File name: C:\Users\lukxg007\OneDrive - WSP\3085\WSSC POP-UP CYCLE SCHEME\THREE BRIDGES\STAGE 2\70073305-CRW-TB-002_COPY.DWG, printed on 08 September 2020 11:55:54, by Gonzalez-Daval, Daniel

HEALTH & SAFETY:
Graphical Representation of Risk Information on Drawing

KEY:

- Indicates a residual risk as a warning
- Indicates a residual risk requiring compulsory action
- Indicates a residual risk requiring a prohibitive action
- Indicates a residual risk for information

LIVE TRAFFIC -
THROUGHOUT SCHEME EXTENTS

BURIED UTILITIES ARE WIDESPREAD -
REFER TO STATUTORY UNDERTAKERS PLANS.

PRIVATE ACCESS -
ACCESS FOR PRIVATE VEHICLES MUST
BE MAINTAINED AT ALL TIMES
THROUGHOUT THE ENTIRE LENGTH OF
THE SCHEME.

EMERGENCY ACCESS -
ACCESS FOR EMERGENCY VEHICLES
MUST BE MAINTAINED AT ALL TIMES
THROUGHOUT THE LENGTH OF THE
SCHEME.

DO NOT SCALE

REPLACE 2No. FULL HEIGHT KERBS WITH BULLNOSE KERB TYPE BN3 IN ACCORDANCE WITH WSSC-SD1-1100-011, IMMEDIATELY TO THE EAST OF THE EXISTING CORDUROY PAVING. TRANSITION KERBS SHALL BE PROVIDED AT TIE INS TO EXISTING.

THE TWO ROWS OF CORDUROY PAVING SHALL BE REPLACED SLIGHTLY FURTHER WEST STARTING IN LINE WITH THE TOP OF THE TRANSITION KERB.

THE FOOTWAY AT THE EXISTING CORDUROY PAVING LOCATION SHALL BE REINSTATED TO MATCH THE ADJACENT FOOTWAYS SURFACE.

KEY:

- EXISTING CYCLE TRACK
- EXISTING FOOTPATH TO BE CONVERTED ONTO A TEMPORARY SHARED USE PATH
- ROAD CYLINDERS - 6m SPACING
- ROAD CYLINDERS - 3m SPACING
- EXISTING TOUCAN CROSSING
- EXISTING CONTROLLED CROSSING TO BE CONVERTED TO A TOUCAN CROSSING

KEY - TRAFFIC SIGNS & ROAD MARKINGS:

TRAFFIC SIGNS:

- S004** TRAFFIC SIGN REF NUMBER
- A-FRAME / STANCHION MOUNTED TRAFFIC SIGN. FRAME TO BE ESTABLISHED USING SANDBAGS WITH PROTECTION TRAFFIC CONES
- TRAFFIC SIGN MOUNTED ON LIGHTING COLUMN / EXISTING POST
- TRAFFIC SIGN MOUNTED ON A NEW SIGN POST.

- FOR NEW SIGN INFORMATION INCLUDING MOUNTING REQUIREMENTS REFER TO SIGN SCHEDULE T4

ROAD MARKINGS:

- M1** NEW ROAD MARKINGS - REFER TO SCHEDULE T9 FOR FURTHER INFORMATION
- RM1** EXISTING ROAD MARKINGS TO BE REMOVED. REFER TO SCHEDULE T7 FOR FURTHER INFORMATION

NOTES:

- PROPOSALS BASED ON ORDNANCE SURVEY MAPPING. TO BE CONFIRMED BY ON-SITE MEASUREMENTS PRIOR TO CONSTRUCTION.
- PERMANENT ROAD MARKINGS SHALL BE THERMOPLASTIC MATERIAL IN ACCORDANCE WITH BS EN 1871. PERMANENT MARKINGS SHALL BE REFLECTORISED IN ACCORDANCE WITH BS EN 1423. FOR WHITE ROAD MARKINGS THE REFLECTIVITY REQUIRED IS CLASS R2.
- WHERE EXISTING ROAD MARKINGS ARE TO BE MASKED OUT BY BLACK COLOUR PAINT THIS SHALL COMPLY WITH BS 7962:2000 WITH AMENDMENT 1, DATED 2004. THE BLACK MASKING MATERIALS SHALL HAVE A MINIMUM CLASS OF 1 SKID RESISTANCE TO TABLE 8 OF BS EN 1436.
- ALL PROPOSED SIGNS MOUNTING ON LIGHTING COLUMNS, THE MOUNTING BRACKETS AND THEIR STAINLESS STEEL BAND STRAP FIXINGS ARE BACKED WITH NEOPRENE RUBBER STRIPS TO PROTECT THE COLUMN SHAFT FROM ANY DAMAGES. THE NEOPRENE STRIPS CAN BE OBTAINED FROM SIGNPOST SOLUTIONS.
- TRAFFIC MANAGEMENT TO BE IN ACCORDANCE WITH TSM CHAPTER 8.

REPRODUCED FROM 2010 ORDNANCE SURVEY MASTER MAPPING WITH THE PERMISSION OF THE CONTROLLER OF HER MAJESTY'S STATIONERY OFFICE CROWN COPYRIGHT. UNAUTHORISED REPRODUCTION INFRINGES CROWN COPYRIGHT AND MAY LEAD TO PROSECUTION OR CIVIL PROCEEDINGS. LICENCE No. W.S.C.C. 100023447

C02	26/08/2020	DG	DELINEATED EASTBOUND CYCLE LANE ALONG HASLETT AVENUE E TO THE EAST OF HAZELWICK AVENUE. HAS BEEN REMOVED, AND SIGNAGE AND ROAD MARKINGS AMENDED AS A RESULT.	DG	PS
C01	18/08/2020	DG	ISSUE FOR CONSTRUCTION	DG	PS
P01	14/08/2020	DG	FIRST DRAFT ISSUE FOR COSTING	DG	
REV	DATE	BY	DESCRIPTION	CHK	APP
DRAWING STATUS: A - FIT FOR CONSTRUCTION					

2 London Square, Cross Lanes, Guildford, Surrey, GU1 1UN
T+ 44 1483 528 400
wsp.com

CLIENT:

WEST SUSSEX COUNTY COUNCIL,
INFRASTRUCTURE GROUP,
COUNTY HALL, WEST STREET,
CHICHESTER, WEST SUSSEX,
PO19 1RH, (01243) 642105.

PROJECT: WSSC TEMP ROAD SPACE REALLOCATIONS (COVID-19) DETAILED DESIGN

TITLE: POUND HILL TO CRAWLEY TOWN CENTRE SCHEME PLANS SHEET 004 OF 004

SCALE @ A1: 1:500	CHECKED: DG	APPROVED: BS
PROJECT No: 70073305	DESIGNED: DG	DRAWN: DG
DATE: September 20		
DRAWING No: 70073305-CRW-TB-004		REV: C02
© WSP UK Ltd		